

House a Home

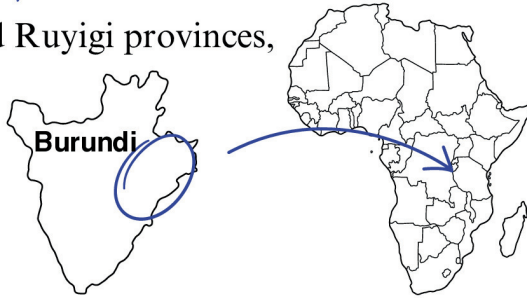

Your gift helps a family build their own **House**, which also builds confidence and independence!

Your Gift of Grace delivered in:
Cankuzo and Ruyigi provinces,
Burundi



How families use your gift to build a house

“It can take 10-12 days to build a small house if you have help.

Step 1: We have to validate our plans with the authorities first to build a house. The traditional houses are all built 5x7m.

Step 2: Once it is approved we start with markings on the ground to measure out the house.

Step 3: We get the mud from our own plot to make the bricks. I myself made all the bricks by hand! Then they have to dry – which can take 7 days.

Step 4: The carpenter comes to construct the wooden frames.

Step 5: Once the walls are built you come to supply the trusses, the iron sheets for the roof, and the nails.”

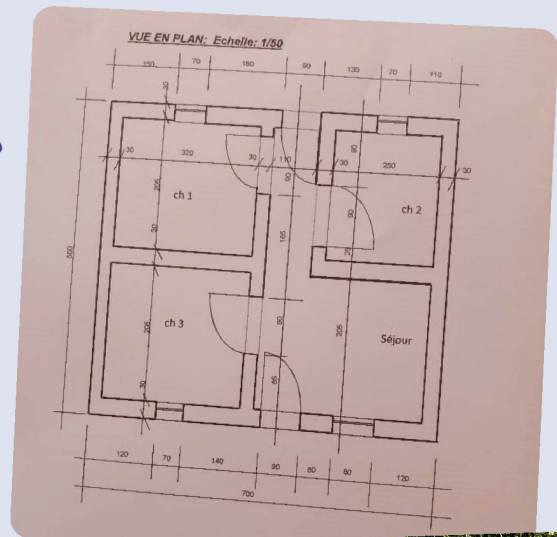

Jean Marie Nduwingoma who built his own home thanks to people like you!



CASE STUDY

“Now I am very comfortable”

“My name is Jean Marie. Thank you for the support and training I received!

I put into practice what I learned.

I learned how to cultivate bananas and sapling trees. I also learned how to use manure for my crops, and modern farming techniques, like planting in rows.

LWF also trained us how to run a Co-op. We learnt how to do savings and provide loans for members.

We started working together as groups of 20-25 people to do loans.

People can take a loan and use it to buy goats or products they need. They have to pay back the loans within 3 months and then they can borrow again.

Before you came to help me, I could only provide 1 meal per day for my family but now we can eat 2-3 times a day!

In the mornings we eat beans and bananas, we can drink tea and sometimes even add sugar. Lunch time we eat rice and beans and vegetables from our field. In the evening we eat casava paste or maize, beans, and vegetables.

We are now a happy and healthy family!

Thanks to your help and the profits I make, I can send my children to school.

I now also build another house on the plot next to mine for my two boys. Because of all the trainings I received I am now the chief of different groups.

My dream is to keep on learning from LWF so that my community can develop more.

If you have a child, it is good to check up on them when they have grown up to see if they are providing for their family. This is the way you also work.

Thank you again for your support! There was nothing here before the support, and now I am very comfortable.”

All photos: ALWS



How your gift grows

The great thing about your gift is it keeps on giving for many years!

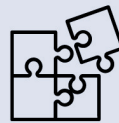

ALWS supports an **integrated approach** to development, which means working across different sectors. For example, if you help build a house, but families don't have food or clean water, the house won't be very useful!



ALWS also follows a **community-based empowerment approach**. This means giving people the training and support to make their own decisions about the development in their community. They have responsibility for the activities, and grow the confidence needed to become self-sufficient.